

CF50 Series 0.50/1.00mm(.020"/.039")H=1.5 SMT ZIF One-Touch FFC/FPC Connectors

- ⊙ 1.46mm above the board
- ⊙ FFC/FPC zero insertion force and high retention force
- ⊙ Insulation: High temperature plastic UL 94V-0, Color Nature
- ⊙ Cover: High temperature plastic UL 94V-0, Color Black
- ⊙ Actuator designed easy for FFC/FPC installation and reliable operation
- ⊙ With metal fixed tabs to secure connector in place

NEW

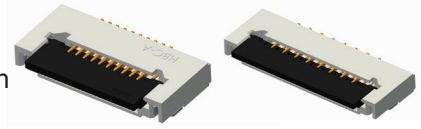

RoHS Compliant

P/N CF50***D0RK-05-NH

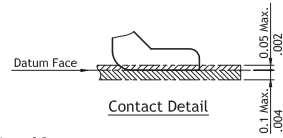
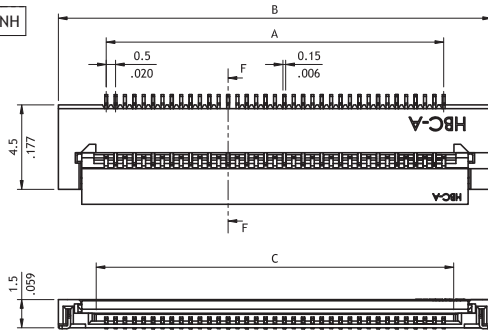

A = 1.0 * No. of Spaces
 B = A + 5.1
 C = A + 1.07

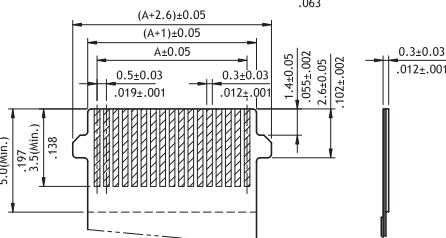
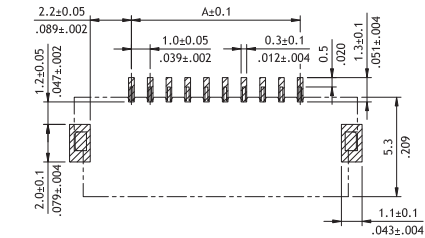
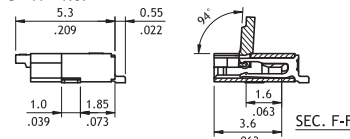

Recommended PCB Layout

Accommodated FFC/FPC

P/N CF50***D0RK-10-NH

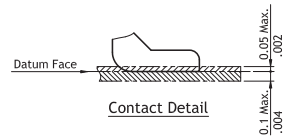
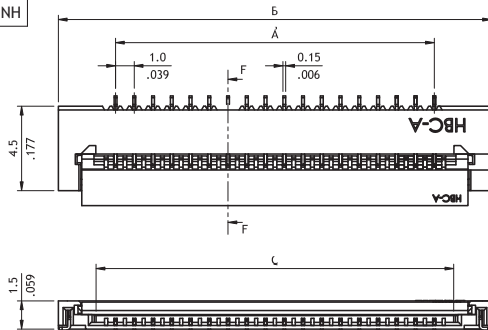

A = 1.0 * No. of Spaces
 B = A + 6.1
 C = A + 2.07

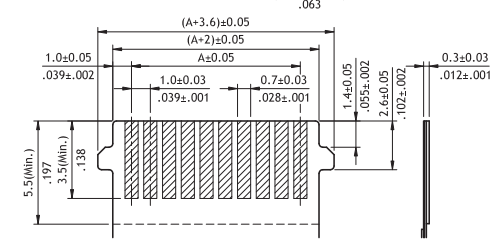
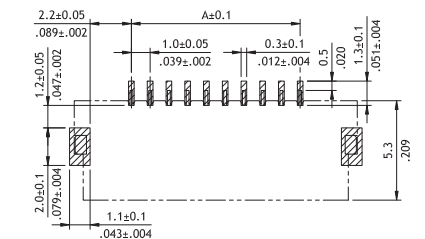
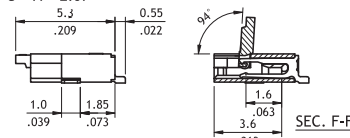

Recommended PCB Layout

Accommodated FFC/FPC

Ordering Code

① ② ③ ④ ⑤ ⑥ ⑦ ⑧
CF 50 10 1 D 0 RK - 10 - NH

- ① Series No.
- ② No. of Circuits:
0.5 pitch: 12, 20, 26
1.0 pitch: 10
- ③ Plating Code:
1 = Matte Tin over Nickel
F = Gold flash over Nickel
- ④ Contact Style:
D = Downside Contact
- ⑤ Color: 0 = Nature
- ⑥ Packing:
RK = Tape & Reel without Mylar
TK = Tube packing
- ⑦ Pitch: 10 = 1.00 mm
05 = 0.50 mm
- ⑧ Process: -NH = For Lead Free IR process and Halogen-Free