

### CBC1 Series 1.27mm(.050") Dual Row Female Headers

- ⊙ Mates with 1.27mm pitch 0.40mm Square pin Header
- ⊙ High performance contact design
- ⊙ Low insertion Force, Anti-flux
- ⊙ With PCB pegs options

RoHS Compliant

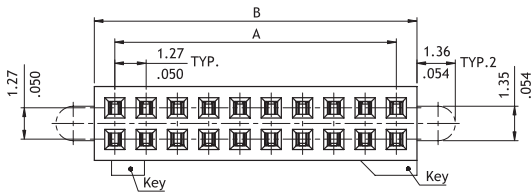
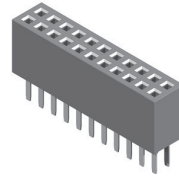

A = 1.27 X No. of Spaces  
 B = A + 1.67  
 C = A + 3.05

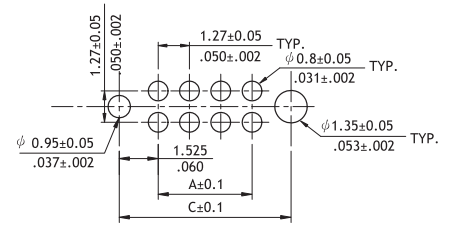
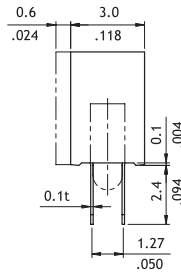
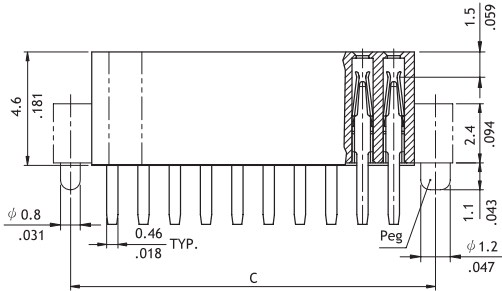

Recommended PCB Layout

#### Ordering Code

①      ②      ③      ④      ⑤      ⑥      ⑦  
**CB C 1   6 0   2   D   1   0 0   -   NH**

- ① Series No.
- ② No. of Circuits:  
 With keys: 10, 20, 30 to 60  
 Without keys: 06 to 60
- ③ Plating Code:  
 2 = Gold flash over Nickel
- ④ Tail Style: D = DIP Type

- ⑤ Color: 1 = Black
- ⑥ Other Options:  
 00 = Without Key and Peg  
 10 = With Keys and Pegs  
 20 = Without Key and With Pegs
- ⑦ Process: -NH = For Lead Free IR process and Halogen-Free