

CF27 Series 0.50mm(.020") H=1.20 SMT LIF FFC/FPC Connectors

- ⊙ 1.2mm above the board
- ⊙ Copper alloy dual contacts
- ⊙ Insulator: High temperature plastic UL 94V-0, Color Nature
- ⊙ With metal fixed tabs to secure connector in place

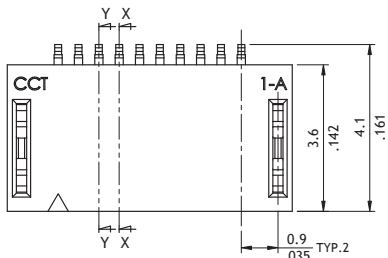

RoHS Compliant



A = 0.5 x No. of Spaces
 B = A + 2.5
 C = A + 1.0
 D = A + 4.5

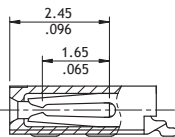
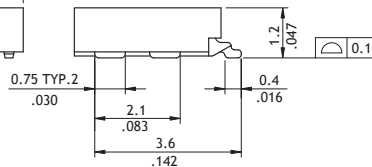
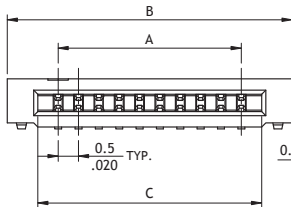

SEC.: Y-Y

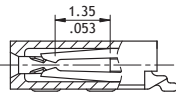

SEC.: X-X

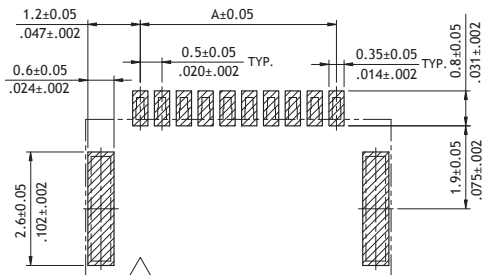
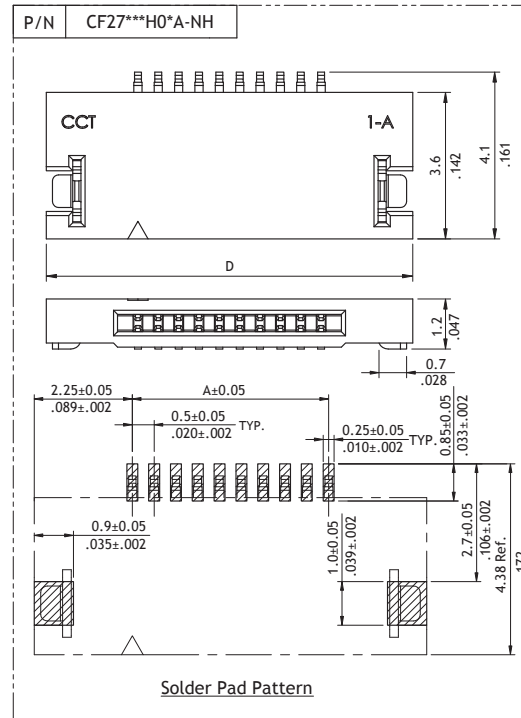

Solder Pad Pattern

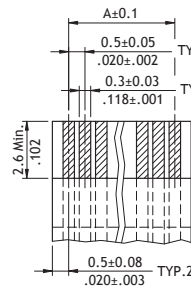

Accommodated FFC

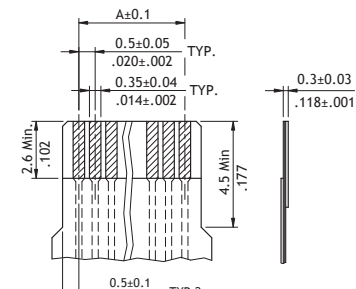

Accommodated FPC

Ordering Code

① CF 27 ② 20 ③ 1 ④ H ⑤ 0 ⑥ R ⑦ 0 - ⑧ NH

- ① Series No.
- ② No. of Circuits: 04 to 20
- ③ Plating Code:
1 = Matte Tin over Nickel
2 = Gold flash over Nickel
- ④ Contact Style:
H = Side Entry
- ⑤ Color: 0 = Nature
- ⑥ Packing:
R = Tape & Reel
T = Tube
- ⑦ Other Options:
0 = Standard
A = Base of Wide size
- ⑧ Process: -NH = For Lead Free
IR process and Halogen-Free