

Notes:

\* Material:

Insulator: Glass filled Polyester UL 94V-0  
Color Black or White

Contact: Brass

△ Shell: Steel, Nickel plated as standard

\* For Lead Free Wave Flow Process

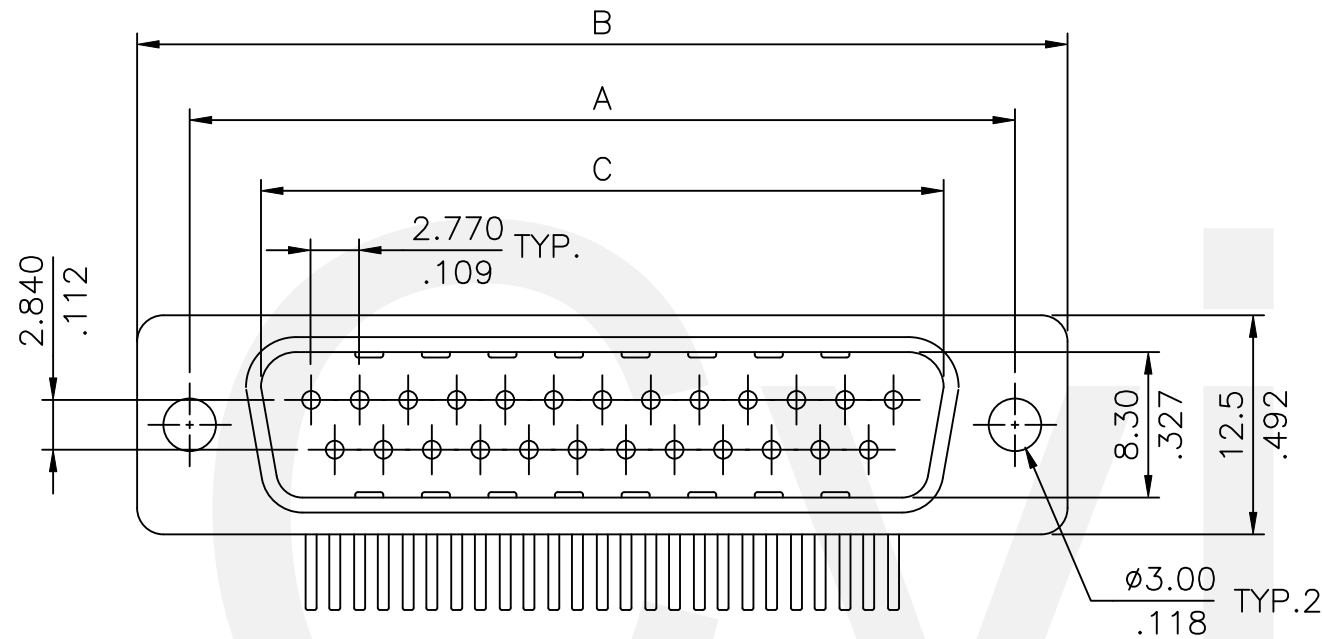

Circuits	Dimension		
	A	B	C
9	25.00(.984)	30.8(1.213)	16.92(.666)
15	33.32(1.312)	39.2(1.543)	25.25(.994)
25	47.04(1.852)	53.1(2.091)	38.96(1.534)
37	63.50(2.500)	69.4(2.732)	55.42(2.182)

Ordering Code :

CD73 25 P \* \* 00  
① ② ③ ④ ⑤ ⑥

- Series No.
- Contacts: 9,15,25,37
- Contact type : P=Plug
- Contact Plating :
  - 2 = Gold flash plated over Nickel
  - 3 =  $0.38\mu\text{m}$ ( $15\mu$ " ) Gold plated over Nickel
  - 4 =  $0.76\mu\text{m}$ ( $30\mu$ " ) Gold plated over Nickel
  - 5 =  $1.27\mu\text{m}$ ( $50\mu$ " ) Gold plated over Nickel
- Insulator Color :
  - 1=Black , 0=White
- Other option :
  - 00 = With  $\phi 3.00\text{mm}$  holes on shell

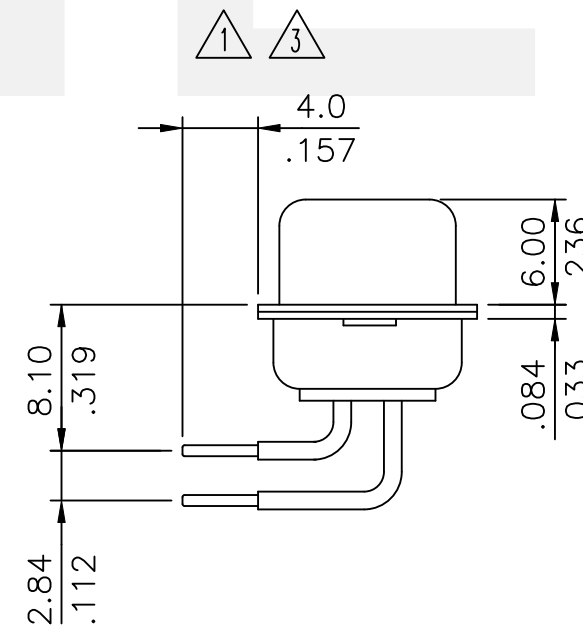
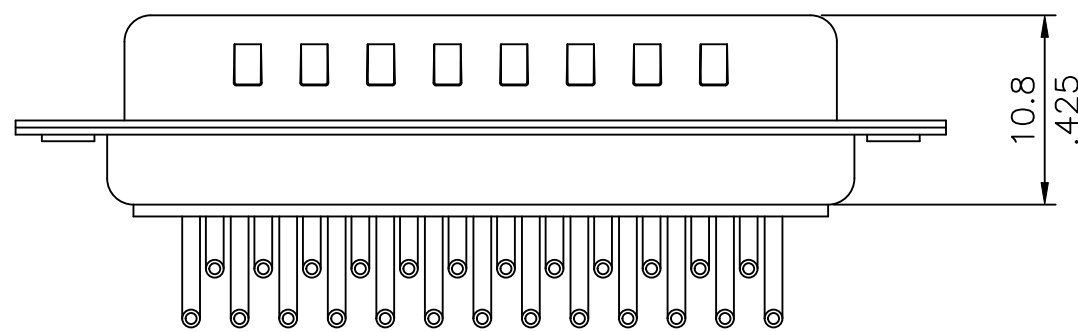

Lead Free Process

RoHS Compliant

REV	SYM	NAME	DATE	REVISIONS	APPROVED BY:	DATE	UNIT: mm / inch	TITLE: D-SUB SIDE ENTRY (8.1mm) MALE CONNECTOR (MACHINED CONTACTOR)
4								
3	Jack	8/5-24'	ECNT124225/ECRT124050		DRAWN BY: Jack	8/5-24'	TOLERANCE UNLESS OTHERWISE SPECIFIED .X ±0.30/.012 X' ± 1" .XX ±0.20/.008 .X' ± .XXX ±0.10/.004 .XX' ±	MATERIAL:
2	Karen	2/23-18'	ECNT117262/ECRT117074		ENGINEER: Sun	8/5-24'		
1	Karen	10/04-11'	ECN11215/ECR11080-0		CHECKED BY: Eisley	8/5-24'		FINISH:
	SYM	NAME	DATE	REVISIONS	APPROVED BY:	DATE		

CviLux Corp  
 2024/08/13  
 ISSUED

瀚荃股份有限公司  
CviLux Corporation

DRAWING NO.	CD7301SG	PART NO.	CD73**P**00
SCALE	2 / 1	SHEET	1 OF 1