

Material:

\* Insulation:

Glass filled polyester UL 94V-0

\* Contact: Brass

Ordering Code:

CA21 \*\* S A 1 \*0  
 ① ② ③ ④ ⑤ ⑥

- ① Series No.
- ② No. of Circuits
- ③ Contact type: S= Socket

④ Plating option:

- A= Selective Gold flash plated over 1.27μm(50μ") Nickel
- B= Selective 0.38μm(15μ") Gold plated over 1.27μm(50μ")Nickel
- C= Selective 0.76μm(30μ") Gold plated over 1.27μm(50μ") Nickel

⑤ Color: 1= Black

- ⑥ Other Options:  
 00= Standard  
 A0= Without Polarizing Rib

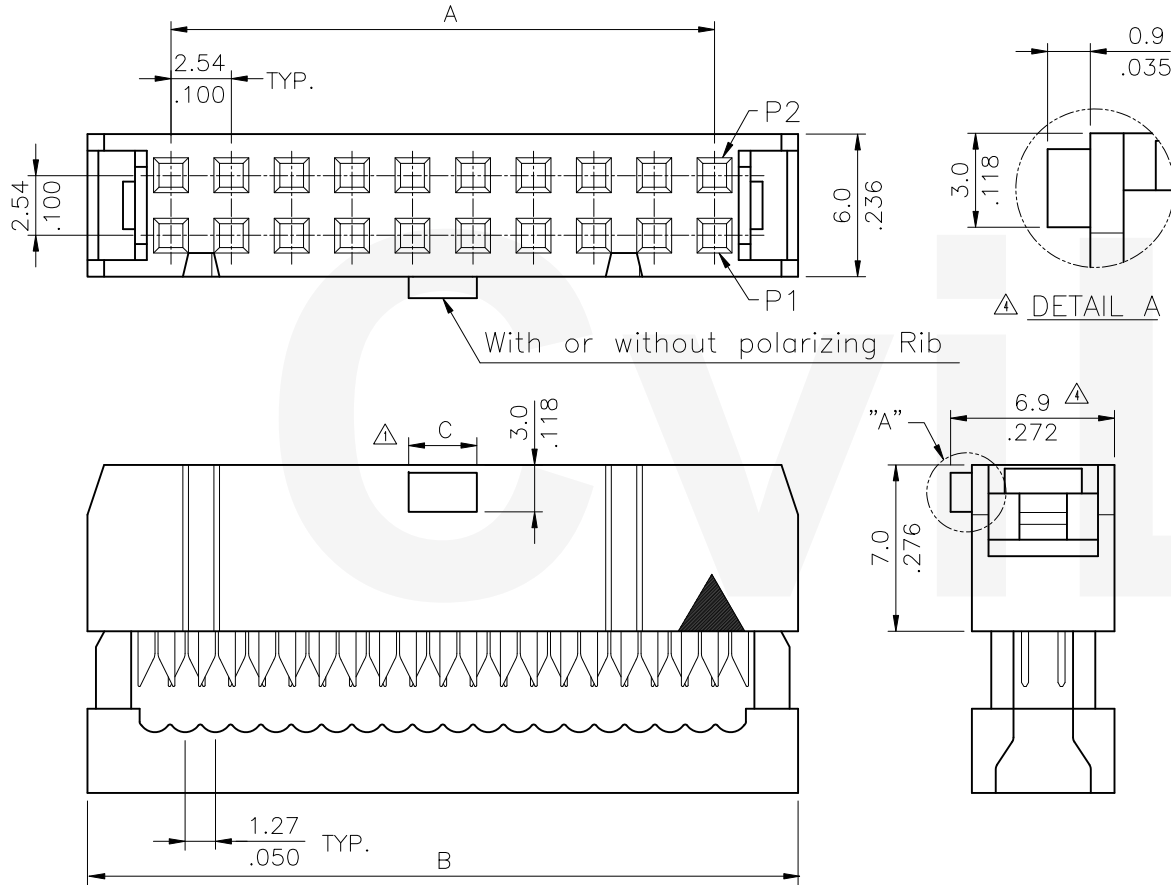

Circuits	Dimension		
	A	B	C
6	5.08(.200)	12.32(.472)	1.85(.072)
8	7.62(.300)	14.86(.585)	1.85(.072)
10	10.16(.400)	17.40(.685)	3.50(.138)
12	12.70(.500)	19.94(.785)	3.50(.138)
14	15.24(.600)	22.48(.885)	3.50(.138)
16	17.78(.700)	25.02(.985)	3.50(.138)
20	22.86(.900)	30.10(1.185)	3.50(.138)
24	27.94(1.100)	35.18(1.381)	3.50(.138)
26	30.48(1.200)	37.72(1.485)	3.50(.138)
30	35.56(1.400)	42.80(1.685)	3.50(.138)
34	40.64(1.600)	47.88(1.885)	3.50(.138)
36	43.18(1.700)	50.42(1.985)	3.50(.138)
40	48.26(1.900)	55.50(2.185)	3.50(.138)
44	53.34(2.100)	60.58(2.385)	3.50(.138)
50	60.96(2.400)	68.20(2.685)	3.50(.138)
56	68.58(2.700)	75.82(2.985)	3.50(.138)
60	73.66(2.900)	80.90(3.185)	3.50(.138)
62	76.20(3.000)	83.44(3.285)	3.50(.138)
64	78.74(3.100)	85.98(3.385)	3.50(.138)

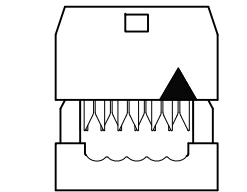

△ 6,8 Citcuits

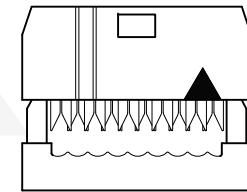

10,12 Citcuits

RoHS Compliant

△	Ken	2/12-19'	ECNT119043		DATE	UNIT: mm / inch	TITLE: 2.54MM(.100")	瀚荃股份有限公司 CviLux Corporation	
△	Ken	1/9-17'	ECRB116097/ECNT117076		DRAWN BY: Ken	2/25-19'	TOLERANCE UNLESS OTHERWISE SPECIFIED		RIBBON CABLE I.D.C. CONNECTOR
△	Kevin	4/8-09'	ECN09188		ENGINEER: Sun	2/25-19'	.X ± 0.30/.012 X' ± 1'		MATERIAL:
△	Karen	8/15-08'	ECN08396		CHECKED BY: Easley	2/27-19'	.XX ± 0.20/.008 X' ±		FINISH:
△	Easley	2/27-19'	REVISIONS	APPROVED BY: Easley	2/27-19'	.XXX ± 0.10/.004 .XX' ±	DRAWING NO. CA2101SL	PART NO. CA21**S*1*0	
							SCALE 3 / 1	SHEET 1 OF 1	