

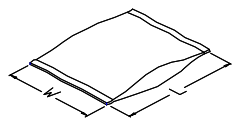

SERIES OR P/N	CIRCUITS	PACKING METHOD CODE	INNER PACKING NO.	INNER PACKING SIZE (CM)			INNER PACKING QTY	INSIDE CARTON NO.	INSIDE CARTON SIZE (CM)			PCS / INSIDE CARTON	CARTON NO.	CARTON SIZE (CM)			PCS / CARTON	G.W REF. (KG)
				L	D	W			H	L	W			H	L	W		
CF1603*D/U0T*/-LF/-H	3	G	PACK-TBC001-C/016-H	60.0	0.88	0.90	72	PACK-IBC014-C/001-H	61.70	6.00	10.20	4752	PACK-CTC011/-C	63.0	15.0	23.0	19008	8.64
CF1604*D/U0T*/-LF/-H	4	G	PACK-TBC001-C/016-H	60.0	0.88	0.90	64	PACK-IBC014-C/001-H	61.70	6.00	10.20	4224	PACK-CTC011/-C	63.0	15.0	23.0	16896	9.13
CF1605*D/U0T*/-LF/-H	5	G	PACK-TBC001-C/016-H	60.0	0.88	0.90	58	PACK-IBC014-C/001-H	61.70	6.00	10.20	3828	PACK-CTC011/-C	63.0	15.0	23.0	15312	9.13
CF1606*D/U0T*/-LF/-H	6	G	PACK-TBC001-C/016-H	60.0	0.88	0.90	52	PACK-IBC014-C/001-H	61.70	6.00	10.20	3432	PACK-CTC011/-C	63.0	15.0	23.0	13728	8.24
CF1607*D/U0T*/-LF/-H	7	G	PACK-TBC001-C/016-H	60.0	0.88	0.90	48	PACK-IBC014-C/001-H	61.70	6.00	10.20	3168	PACK-CTC011/-C	63.0	15.0	23.0	12672	8.78
CF1608*D/U0T*/-LF/-H	8	G	PACK-TBC001-C/016-H	60.0	0.88	0.90	44	PACK-IBC014-C/001-H	61.70	6.00	10.20	2904	PACK-CTC011/-C	63.0	15.0	23.0	11616	8.73
CF1609*D/U0T*/-LF/-H	9	G	PACK-TBC001-C/016-H	60.0	0.88	0.90	41	PACK-IBC014-C/001-H	61.70	6.00	10.20	2706	PACK-CTC011/-C	63.0	15.0	23.0	10824	8.91
CF1610*D/U0T*/-LF/-H	10	G	PACK-TBC001-C/016-H	60.0	0.88	0.90	38	PACK-IBC014-C/001-H	61.70	6.00	10.20	2508	PACK-CTC011/-C	63.0	15.0	23.0	10032	8.81
CF1611*D/U0T*/-LF/-H	11	G	PACK-TBC001-C/016-H	60.0	0.88	0.90	36	PACK-IBC014-C/001-H	61.70	6.00	10.20	2376	PACK-CTC011/-C	63.0	15.0	23.0	9504	8.70
CF1612*D/U0T*/-LF/-H	12	G	PACK-TBC001-C/016-H	60.0	0.88	0.90	34	PACK-IBC014-C/001-H	61.70	6.00	10.20	2244	PACK-CTC011/-C	63.0	15.0	23.0	8976	8.72
CF1613*D/U0T*/-LF/-H	13	G	PACK-TBC001-C/016-H	60.0	0.88	0.90	32	PACK-IBC014-C/001-H	61.70	6.00	10.20	2112	PACK-CTC011/-C	63.0	15.0	23.0	8448	9.01
CF1614*D/U0T*/-LF/-H	14	G	PACK-TBC001-C/016-H	60.0	0.88	0.90	30	PACK-IBC014-C/001-H	61.70	6.00	10.20	1980	PACK-CTC011/-C	63.0	15.0	23.0	7920	9.09
CF1615*D/U0T*/-LF/-H	15	G	PACK-TBC001-C/016-H	60.0	0.88	0.90	29	PACK-IBC014-C/001-H	61.70	6.00	10.20	1914	PACK-CTC011/-C	63.0	15.0	23.0	7656	9.09
CF1616*D/U0T*/-LF/-H	16	G	PACK-TBC001-C/016-H	60.0	0.88	0.90	27	PACK-IBC014-C/001-H	61.70	6.00	10.20	1782	PACK-CTC011/-C	63.0	15.0	23.0	7128	9.22
CF1617*D/U0T*/-LF/-H	17	G	PACK-TBC001-C/016-H	60.0	0.88	0.90	26	PACK-IBC014-C/001-H	61.70	6.00	10.20	1716	PACK-CTC011/-C	63.0	15.0	23.0	6864	9.07
CF1618*D/U0T*/-LF/-H	18	G	PACK-TBC001-C/016-H	60.0	0.88	0.90	25	PACK-IBC014-C/001-H	61.70	6.00	10.20	1650	PACK-CTC011/-C	63.0	15.0	23.0	6600	9.03
CF1619*D/U0T*/-LF/-H	19	G	PACK-TBC001-C/016-H	60.0	0.88	0.90	24	PACK-IBC014-C/001-H	61.70	6.00	10.20	1584	PACK-CTC011/-C	63.0	15.0	23.0	6336	9.14
CF1620*D/U0T*/-LF/-H	20	G	PACK-TBC001-C/016-H	60.0	0.88	0.90	23	PACK-IBC014-C/001-H	61.70	6.00	10.20	1518	PACK-CTC011/-C	63.0	15.0	23.0	6072	9.16
CF1621*D/U0T*/-LF/-H	21	G	PACK-TBC001-C/016-H	60.0	0.88	0.90	22	PACK-IBC014-C/001-H	61.70	6.00	10.20	1452	PACK-CTC011/-C	63.0	15.0	23.0	5808	9.10
CF1622*D/U0T*/-LF/-H	22	G	PACK-TBC001-C/016-H	60.0	0.88	0.90	21	PACK-IBC014-C/001-H	61.70	6.00	10.20	1386	PACK-CTC011/-C	63.0	15.0	23.0	5544	8.78
CF1623*D/U0T*/-LF/-H	23	G	PACK-TBC001-C/016-H	60.0	0.88	0.90	20	PACK-IBC014-C/001-H	61.70	6.00	10.20	1320	PACK-CTC011/-C	63.0	15.0	23.0	5280	9.34
CF1624*D/U0T*/-LF/-H	24	G	PACK-TBC001-C/016-H	60.0	0.88	0.90	20	PACK-IBC014-C/001-H	61.70	6.00	10.20	1320	PACK-CTC011/-C	63.0	15.0	23.0	5280	9.05
CF1625*D/U0T*/-LF/-H	25	G	PACK-TBC001-C/016-H	60.0	0.88	0.90	19	PACK-IBC014-C/001-H	61.70	6.00	10.20	1254	PACK-CTC011/-C	63.0	15.0	23.0	5016	9.17
CF1626*D/U0T*/-LF/-H	26	G	PACK-TBC001-C/016-H	60.0	0.88	0.90	18	PACK-IBC014-C/001-H	61.70	6.00	10.20	1188	PACK-CTC011/-C	63.0	15.0	23.0	4752	9.10
CF1627*D/U0T*/-LF/-H	27	G	PACK-TBC001-C/016-H	60.0	0.88	0.90	18	PACK-IBC014-C/001-H	61.70	6.00	10.20	1188	PACK-CTC011/-C	63.0	15.0	23.0	4752	9.23
CF1628*D/U0T*/-LF/-H	28	G	PACK-TBC001-C/016-H	60.0	0.88	0.90	17	PACK-IBC014-C/001-H	61.70	6.00	10.20	1122	PACK-CTC011/-C	63.0	15.0	23.0	4488	8.98
CF1629*D/U0T*/-LF/-H	29	G	PACK-TBC001-C/016-H	60.0	0.88	0.90	16	PACK-IBC014-C/001-H	61.70	6.00	10.20	1056	PACK-CTC011/-C	63.0	15.0	23.0	4224	9.02
CF1630*D/U0T*/-LF/-H	30	G	PACK-TBC001-C/016-H	60.0	0.88	0.90	16	PACK-IBC014-C/001-H	61.70	6.00	10.20	1056	PACK-CTC011/-C	63.0	15.0	23.0	4224	9.14

PACKING METHOD (包裝方式) :

1 PVC BAG (塑膠袋)
SIZE = L * W



2 TUBE (塑膠管)
SIZE = L * W * H

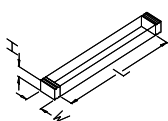

3 PVC TRAY (塑膠盒)
SIZE = L * W * H

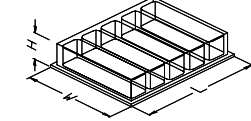

4 REEL (紙盤)
SIZE = D * W

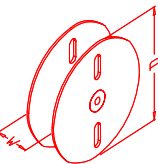

5 BOX (內紙盒)
SIZE = L * W * H

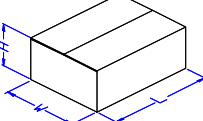

6 INSIDE CARTON (內箱)
SIZE = L * W * H

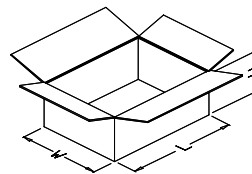

7 OUTSIDE CARTON (外箱)
SIZE = L * W * H

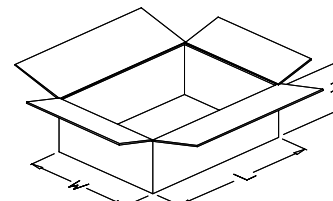

PACKING METHOD CODE (包裝方式代碼) :

- A = 1 → 7
- B = 2 → 7
- C = 3 → 7
- D = 4 → 7
- E = 5 → 7
- F = 1 → 6 → 7
- G = (2+1) → 6 → 7
- H = 3 → 6 → 7



瀚萃股份有限公司
CviLux Corporation
PACKING STANDARD

製訂日期：2009/7/2

SERIES OR P/N	CIRCUITS	PACKING METHOD CODE	INNER PACKING NO.	INNER PACKING SIZE (CM)			INNER PACKING QTY	INSIDE CARTON NO.	INSIDE CARTON SIZE (CM)			PCS / INSIDE CARTON	CARTON NO.	CARTON SIZE (CM)			PCS / CARTON	G.W REF. (KG)
				L/D	W	H			L	W	H			L	W	H		
CF1631*D/U0T*/-LF/-H	31	G	PACK-TBC001-C/016-H	60.0	0.88	0.90	16	PACK-IBC014-C/001-H	61.70	6.00	10.20	1056	PACK-CTC011-C	63.0	15.0	23.0	4224	9.27
CF1632*D/U0T*/-LF/-H	32	G	PACK-TBC001-C/016-H	60.0	0.88	0.90	15	PACK-IBC014-C/001-H	61.70	6.00	10.20	990	PACK-CTC011-C	63.0	15.0	23.0	3960	1.07

PACKING METHOD (包裝方式) :

1 PVC BAG (塑膠袋)
SIZE = L * W

2 TUBE (塑膠管)
SIZE = L * W * H

3 PVC TRAY (塑膠盒)
SIZE = L * W * H

4 REEL (紙盤)
SIZE = D * W

5 BOX (內紙盒)
SIZE = L * W * H

6 INSIDE CARTON (內箱)
SIZE = L * W * H

7 OUTSIDE CARTON (外箱)
SIZE = L * W * H

PACKING METHOD CODE (包裝方式代碼) :

- A = 1 → 7
- B = 2 → 7
- C = 3 → 7
- D = 4 → 7
- E = 5 → 7
- F = 1 → 6 → 7
- G = (2+1) → 6 → 7
- H = 3 → 6 → 7