

PACKING STANDARD

製訂日期：2023/11/03

SERIES OR P/N	CIRCUITS	PACKING METHOD CODE	INNER PACKING NO.	INNER PACKING SIZE (CM)			INNER PACKING QTY	INSIDE CARTON NO.	INSIDE CARTON SIZE (CM)			PCS / INSIDE CARTON	CARTON NO.	CARTON SIZE (CM)			PCS / CARTON	G.W REF. (KG)
				L / D	W	H			L	W	H			L	W	H		
CP3502P*VST/-LF/-NH	2	D	PACK-CRCB44-C	-	2.40	-	250	PACK-RLCB01-C	-	2.55	-	250	PACK-CTC034-C	35.0	35.0	32.0	2250	5.05
CP3504P*VST/-LF/-NH	4	D	PACK-CRCB45-C	-	2.40	-	250	PACK-RLCB01-C	-	2.55	-	250	PACK-CTC034-C	35.0	35.0	32.0	2250	5.46
CP3506P*VST/-LF/-NH	6	D	PACK-CRCC25-C	-	3.20	-	250	PACK-RLCC01-C	-	3.35	-	250	PACK-CTC034-C	35.0	35.0	32.0	1750	5.33
CP3508P*VST/-LF/-NH	8	D	PACK-CRCD81-C	-	4.40	-	250	PACK-RLCD01-C	-	4.55	-	250	PACK-CTC034-C	35.0	35.0	32.0	1250	4.10
CP3510P*VST/-LF/-NH	10	D	PACK-CRCD50-C	-	4.40	-	250	PACK-RLCD01-C	-	4.55	-	250	PACK-CTC034-C	35.0	35.0	32.0	1250	4.32
CP3512P*VST/-LF/-NH	12	D	PACK-CRCD51-C	-	4.40	-	250	PACK-RLCD01-C	-	4.55	-	250	PACK-CTC034-C	35.0	35.0	32.0	1250	5.86
CP3514P*VST/-LF/-NH	14	D	PACK-CRCD52-C	-	4.40	-	250	PACK-RLCD01-C	-	4.55	-	250	PACK-CTC034-C	35.0	35.0	32.0	1250	4.78
CP3516P*VST/-LF/-NH	16	D	PACK-CRCD53-C	-	4.40	-	250	PACK-RLCD01-C	-	4.55	-	250	PACK-CTC034-C	35.0	35.0	32.0	1250	5.00
CP3518P*VST/-LF/-NH	18	D	PACK-CRCE07-C	-	5.60	-	250	PACK-RLCE01-C	-	5.75	-	250	PACK-CTC034-C	35.0	35.0	32.0	1000	4.91
CP3520P*VST/-LF/-NH	20	D	PACK-CRCE08-C	-	5.60	-	250	PACK-RLCE01-C	-	5.75	-	250	PACK-CTC034-C	35.0	35.0	32.0	1000	5.09
CP3522P*VST/-LF/-NH	22	D	PACK-CRCE09-C	-	5.60	-	250	PACK-RLCE01-C	-	5.75	-	250	PACK-CTC034-C	35.0	35.0	32.0	1000	5.28
CP3524P*VST/-LF/-NH	24	D	PACK-CRCE10-C	-	5.60	-	250	PACK-RLCE01-C	-	5.75	-	250	PACK-CTC034-C	35.0	35.0	32.0	1000	5.46
CP3506P*VST-NH-TS	6	D	PACK-CRCC25-C	-	3.20	-	250	PACK-RLCC01-C	-	3.35	-	250	PACK-CTC034-C	35.0	35.0	32.0	1750	5.33
CP3502P*VSA/-LF/-NH	2	D	PACK-CRCB44-C	-	2.40	-	250	PACK-RLCB01-C	-	2.55	-	250	PACK-CTC034-C	35.0	35.0	32.0	2250	#REF!
CP3504P*VSA/-LF/-NH	4	D	PACK-CRCB45-C	-	2.40	-	250	PACK-RLCB01-C	-	2.55	-	250	PACK-CTC034-C	35.0	35.0	32.0	2250	0.95
CP3506P*VSA/-LF/-NH	6	D	PACK-CRCC25-C	-	3.20	-	250	PACK-RLCC01-C	-	3.35	-	250	PACK-CTC034-C	35.0	35.0	32.0	1750	0.95
CP3508P*VSA/-LF/-NH	8	D	PACK-CRCD81-C	-	4.40	-	250	PACK-RLCD01-C	-	4.55	-	250	PACK-CTC034-C	35.0	35.0	32.0	1250	0.95
CP3510P*VSA/-LF/-NH	10	D	PACK-CRCD50-C	-	4.40	-	250	PACK-RLCD01-C	-	4.55	-	250	PACK-CTC034-C	35.0	35.0	32.0	1250	0.95
CP3512P*VSA/-LF/-NH	12	D	PACK-CRCD51-C	-	4.40	-	250	PACK-RLCD01-C	-	4.55	-	250	PACK-CTC034-C	35.0	35.0	32.0	1250	0.95
CP3514P*VSA/-LF/-NH	14	D	PACK-CRCD52-C	-	4.40	-	250	PACK-RLCD01-C	-	4.55	-	250	PACK-CTC034-C	35.0	35.0	32.0	1250	0.95
CP3516P*VSA/-LF/-NH	16	D	PACK-CRCD53-C	-	4.40	-	250	PACK-RLCD01-C	-	4.55	-	250	PACK-CTC034-C	35.0	35.0	32.0	1250	0.95
CP3518P*VSA/-LF/-NH	18	D	PACK-CRCE07-C	-	5.60	-	250	PACK-RLCE01-C	-	5.75	-	250	PACK-CTC034-C	35.0	35.0	32.0	1000	0.95
CP3520P*VSA/-LF/-NH	20	D	PACK-CRCE08-C	-	5.60	-	250	PACK-RLCE01-C	-	5.75	-	250	PACK-CTC034-C	35.0	35.0	32.0	1000	0.95
CP3522P*VSA/-LF/-NH	22	D	PACK-CRCE09-C	-	5.60	-	250	PACK-RLCE01-C	-	5.75	-	250	PACK-CTC034-C	35.0	35.0	32.0	1000	0.95
CP3524P*VSA/-LF/-NH	24	D	PACK-CRCE10-C	-	5.60	-	250	PACK-RLCE01-C	-	5.75	-	250	PACK-CTC034-C	35.0	35.0	32.0	1000	0.95

PACKING METHOD (包裝方式) :

1 PE BAG (塑膠袋)  
SIZE = L \* W

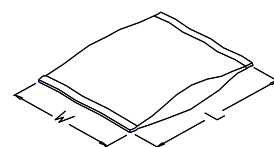

2 TUBE (塑膠管)  
SIZE = L \* W \* H

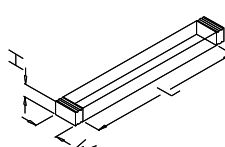

3 PVC TRAY (塑膠盒)  
SIZE = L \* W \* H

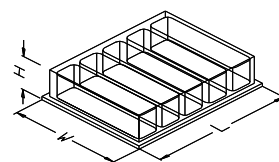

4 REEL (卷盤)  
SIZE = D \* W

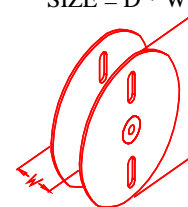

5 BOX (內紙盒)  
SIZE = L \* W \* H

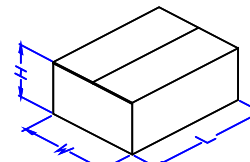

6 INSIDE CARTON (內箱)  
SIZE = L \* W \* H

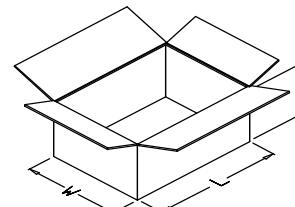

7 OUTSIDE CARTON (外箱)  
SIZE = L \* W \* H

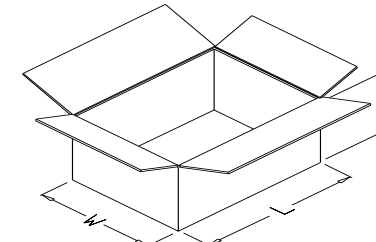

PACKING METHOD CODE (包裝方式代碼) :

- A = 1 → 7
- B = 2 → 7
- C = 3 → 7
- D = (4+1) → 7
- E = 5 → 7
- F = 1 → 6 → 7
- G = (2+1) → 7
- H = 3 → 6 → 7



PACKING STANDARD

SERIES OR P/N	CIRCUITS	PACKING METHOD CODE	INNER PACKING NO.	INNER PACKING SIZE (CM)			INNER PACKING QTY	INSIDE CARTON NO.	INSIDE CARTON SIZE (CM)			PCS / INSIDE CARTON	CARTON NO.	CARTON SIZE (CM)			PCS / CARTON	G.W REF. (KG)
				L	D	W			L	W	H			L	W	H		
CP3506P*VSR-LF	6	D	PACK-CRCB309-C	-	2.40	-	200	PACK-RLCB01-C	-	2.55	-	200	PACK-CTC034-C	35.0	35.0	32.0	1800	
CP3508P*VSR-LF	8	D	PACK-CRCC191-C	-	3.20	-	200	PACK-RLCB01-C	-	3.35	-	200	PACK-CTC034-C	35.0	35.0	32.0	1400	
CP316P*VSR-LF	16	D	PACK-CRCD302-C	-	4.40	-	200	PACK-RLCB01-C	-	4.55	-	200	PACK-CTC034-C	35.0	35.0	32.0	1000	
CP3520P*VSR-LF	20	D	PACK-CRCE115-C	-	5.60	-	200	PACK-RLCB01-C	-	5.75	-	200	PACK-CTC034-C	35.0	35.0	32.0	800	
CP3506P*VSD-NH/-LF/-NH	6	D	PACK-CRCC205-C	-	3.20	-	250	PACK-RLCC01-C	-	3.35	-	250	PACK-CTC034-C	35.0	35.0	32.0	1750	0.95
CP3502P*VST-S-LF/-LF/-NH	2	D	PACK-CRCC107-C	-	3.20	-	200	PACK-RLCC01-C	-	3.35	-	200	PACK-CTC034-C	35.0	35.0	32.0	1400	6.51
CP3503P*VST-S-LF/-LF/-NH	3	D	PACK-CRCC102-C	-	3.20	-	200	PACK-RLCC01-C	-	3.35	-	200	PACK-CTC034-C	35.0	35.0	32.0	1400	6.60
CP3504P*VST-S-LF/-LF/-NH	4	D	PACK-CRCD172-C	-	4.40	-	200	PACK-RLCD01-C	-	4.55	-	200	PACK-CTC034-C	35.0	35.0	32.0	1000	6.60
CP3505P*VST-S-LF/-LF/-NH	5	D	PACK-CRCD178-C	-	4.40	-	200	PACK-RLCD01-C	-	4.55	-	200	PACK-CTC034-C	35.0	35.0	32.0	1000	6.60
CP3506P*VST-S-LF/-LF/-NH	6	D	PACK-CRCD266-C	-	4.40	-	200	PACK-RLCD01-C	-	4.55	-	200	PACK-CTC034-C	35.0	35.0	32.0	1000	6.54
CP3507P*VST-S-LF/-LF/-NH	7	D	PACK-CRCD147-C	-	4.40	-	200	PACK-RLCD01-C	-	4.55	-	200	PACK-CTC034-C	35.0	35.0	32.0	1000	6.54
CP3508P*VST-S-LF/-LF/-NH	8	D	PACK-CRCE72-C	-	5.60	-	200	PACK-RLCE01-C	-	5.75	-	200	PACK-CTC034-C	35.0	35.0	32.0	800	6.73
CP3510P*VST-S-LF/-LF/-NH	10	D	PACK-CRCE73-C	-	5.60	-	200	PACK-RLCE01-C	-	5.75	-	200	PACK-CTC034-C	35.0	35.0	32.0	800	6.84
CP3512P*VST-S-LF/-LF/-NH	12	D	PACK-CRCE60-C	-	5.60	-	200	PACK-RLCE01-C	-	5.75	-	200	PACK-CTC034-C	35.0	35.0	32.0	800	6.93
					W	H												
CP3502P*VS0-S-R0/-LF/-NH	2	D	PACK-CRCB425-C	-	2.40	-	250	PACK-RLCB01-C	-	2.55	-	250	PACK-CTC034-C	35.0	35.0	32.0	2250	
CP3503P*VS0-S-R0/-LF/-NH	3	D	PACK-CRCC223-C	-	3.20	-	250	PACK-RLCB01-C	-	3.35	-	250	PACK-CTC034-C	35.0	35.0	32.0	1750	
CP3502P1VSH-S-R0/-LF/-NH	2	D	PACK-CRCB849-C	-	2.40	-	250	PACK-RLCB01-C	-	2.55	-	250	PACK-CTC034-C	35.0	35.0	32.0	2250	
CP3504P1VSH-S-R0/-LF/-NH	4	D	PACK-CRCC260-C	-	3.20	-	250	PACK-RLCB01-C	-	3.35	-	250	PACK-CTC034-C	35.0	35.0	32.0	1750	
CP3502P1VSH-S-RA-NH/-LF	2	D	PACK-CRCB849-C	-	2.40	-	250	PACK-RLCB01-C	-	2.55	-	250	PACK-CTC034-C	35.0	35.0	32.0	2250	
CP3503P1VST-S-NH-T	3	D	PACK-CRCC102-C	-	3.20	-	200	PACK-RLCC01-C	-	3.35	-	200	PACK-CTC034-C	35.0	35.0	32.0	1400	6.60

注：塑膠盤先用塑膠袋 (PACK-PBC0\*\*-C不打孔) 裝好后再裝入外箱。  
外箱中有紙板(PACK-STC016-C)兩塊、隔板(PACK-STC001-C)四個。

PACKING METHOD (包裝方式) :

1 PE BAG  
(塑膠袋)  
SIZE = L \* W

2 TUBE  
(塑膠管)  
SIZE = L \* W \* H

3 PVC TRAY  
(塑膠盒)  
SIZE = L \* W \* H

4 REEL  
(卷盤)  
SIZE = D \* W

5 BOX  
(內紙盒)  
SIZE = L \* W \* H

6 INSIDE CARTON  
(內箱)  
SIZE = L \* W \* H

7 OUTSIDE CARTON  
(外箱)  
SIZE = L \* W \* H

PACKING METHOD CODE (包裝方式代碼) :

- A = 1 → 7
- B = 2 → 7
- C = 3 → 7
- D = (4+1) → 7
- E = 5 → 7
- F = 1 → 6 → 7
- G = (2+1) → 7
- H = 3 → 6 → 7

## 文件履歷表

文件編號	CI15P355				
文件名稱	<b>PACKING STANDARD</b>				
內容變更敘述					
版本	新增 CP3504P1VSH-S-R0-NH 包規				發行日期
16	編號：ISOXR0182005003				2023.06.27
核准	Scott	審核	Kate	製表	李述元
版本	新增：CP3506P*VST-NH-TS CP3502P1VSH-S-RA-NH/-LF				發行日期
17	編號：ISOXR0182307004				2023.08.09
核准	Scott	審核	Angela	製表	李述元
版本	新增 CP3503P1VST-S-NH-T				發行日期
18	編號：ISOXR0182311001				2023.11.06
核准	Scott	審核	Angela	製表	Angela
版本					發行日期
核准		審核		製表	
版本					發行日期
核准		審核		製表	
版本					發行日期
核准		審核		製表	
版本					發行日期
核准		審核		製表	