



瀚萃股份有限公司
CviLux Corporation
PACKING STANDARD

SERIES OR P/N	CIRCUITS	PACKING METHOD CODE	INNER PACKING NO.	INNER PACKING SIZE (CM)			INNER PACKING QTY	INSIDE CARTON NO.	INSIDE CARTON SIZE (CM)			PCS / INSIDE CARTON	CARTON NO.	CARTON SIZE (CM)			PCS / CARTON	G.W REF. (KG)
				L/D	W	H			L	W	H			L	W	H		
CI0602P*V**/-LF	2	F	PACK-PBC003-C/H	25.0	16.0	0.08	1000	PACK-IBC006-C/H	31.8	24.8	11.2	16000	PACK-CTC002-C	34.5	26.0	25.3	32000	7.83
CI0603P*V**/-LF	3	F	PACK-PBC003-C/H	29.0	23.0	0.08	1000	PACK-IBC006-C/H	31.8	24.8	11.2	10000	PACK-CTC002-C	34.5	26.0	25.3	20000	8.10
CI0604P*V**/-LF	4	F	PACK-PBC002-C/H	29.0	23.0	0.08	1000	PACK-IBC006-C/H	31.8	24.8	11.2	9000	PACK-CTC002-C	34.5	26.0	25.3	18000	8.23
CI0605P*V**/-LF	5	F	PACK-PBC002-C/H	29.0	23.0	0.08	1000	PACK-IBC006-C/H	31.8	24.8	11.2	8000	PACK-CTC002-C	34.5	26.0	25.3	16000	9.82
CI0606P*V**/-LF	6	F	PACK-PBC002-C/H	29.0	23.0	0.08	1000	PACK-IBC006-C/H	31.8	24.8	11.2	6000	PACK-CTC002-C	34.5	26.0	25.3	12000	9.81
CI0607P*V**/-LF	7	F	PACK-PBC002-C/H	29.0	23.0	0.08	1000	PACK-IBC006-C/H	31.8	24.8	11.2	5000	PACK-CTC002-C	34.5	26.0	25.3	10000	13.71
CI0608P*V**/-LF	8	F	PACK-PBC002-C/H	29.0	23.0	0.08	1000	PACK-IBC006-C/H	31.8	24.8	11.2	5000	PACK-CTC002-C	34.5	26.0	25.3	10000	8.72
CI0609P*V**/-LF	9	F	PACK-PBC002-C/H	29.0	23.0	0.08	500	PACK-IBC006-C/H	31.8	24.8	11.2	4000	PACK-CTC002-C	34.5	26.0	25.3	8000	8.35
CI0610P*V**/-LF	10	F	PACK-PBC002-C/H	29.0	23.0	0.08	500	PACK-IBC006-C/H	31.8	24.8	11.2	3000	PACK-CTC002-C	34.5	26.0	25.3	6000	7.69
CI0611P*V**/-LF	11	F	PACK-PBC001-C/H	31.5	27.5	0.08	500	PACK-IBC006-C/H	31.8	24.8	11.2	3000	PACK-CTC002-C	34.5	26.0	25.3	6000	6.81
CI0612P*V**/-LF	12	F	PACK-PBC001-C/H	31.5	27.5	0.08	500	PACK-IBC006-C/H	31.8	24.8	11.2	3000	PACK-CTC002-C	34.5	26.0	25.3	6000	7.47
CI0613P*V**/-LF	13	F	PACK-PBC001-C/H	31.5	27.5	0.08	500	PACK-IBC006-C/H	31.8	24.8	11.2	3000	PACK-CTC002-C	34.5	26.0	25.3	6000	3.71
CI614P*V**/-LF	14	F	PACK-PBC001-C/H	31.5	27.5	0.08	500	PACK-IBC006-C/H	31.8	24.8	11.2	2500	PACK-CTC002-C	34.5	26.0	25.3	5000	3.94
CI0615P*V**/-LF	15	F	PACK-PBC001-C/H	31.5	27.5	0.08	500	PACK-IBC006-C/H	31.8	24.8	11.2	2000	PACK-CTC002-C	34.5	26.0	25.3	4000	6.95
注：-NH,依以上相同pin數包裝,CI0612P1V00-LF除外。																		
CI0612P1V00-LF	12	I	PACK-PBC001-C/H	31.5	27.5	0.08	500	PACK-PTC069/070-C	31.8	24.8	6	1000	PACK-CTC002-C	34.5	26.0	25.3	4000	

PACKING METHOD (包裝方式)：

1 PVC BAG (塑膠袋)
SIZE = L * W

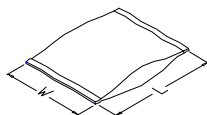

2 TUBE (塑膠管)
SIZE = L * W * H

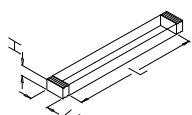

3 PVC TRAY (塑膠盒)
SIZE = L * W * H

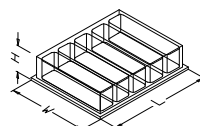

4 REEL (紙盤)
SIZE = D * W

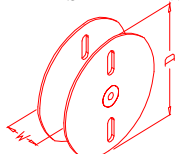

5 BOX (內紙盒)
SIZE = L * W * H

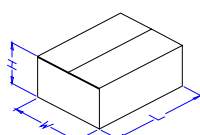

6 INSIDE CARTON (內箱)
SIZE = L * W * H

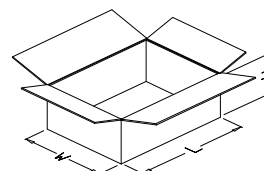

7 OUTSIDE CARTON (外箱)
SIZE = L * W * H

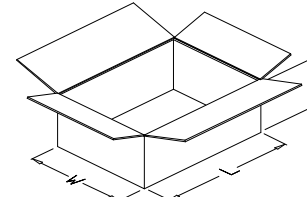

PACKING METHOD CODE (包裝方式代碼)：

- A = 1 → 7
- B = 2 → 7
- C = 3 → 7
- D = 4 → 7
- E = 5 → 7
- F = 1 → 6 → 7
- G = 2 → 6 → 7
- H = 3 → 6 → 7
- I = 1 → 3 → 7

文件履歷表

文件編號	CI15I062				
文件名稱	PACKING STANDARD				
內容變更敘述					
版本	CI0612P1V00-LF 原包裝 PACK-IBC002-C 改用 PACK-PTC069/70-C 包裝				發行日期
11	簽呈編號：ISOXR0181606013				2016.06.22
核准	Jackal	審核	Mavis	製表	李述元
版本	變更數量				發行日期
12	簽呈編號：ISOXR0181612013				2016.12.23
核准	Jackal	審核	Mavis	製表	李述元
版本					發行日期
核准		審核		製表	
版本					發行日期
核准		審核		製表	
版本					發行日期
核准		審核		製表	
版本					發行日期
核准		審核		製表	
版本					發行日期
核准		審核		製表	
版本					發行日期
核准		審核		製表	