

PACKING STANDARD

製訂日期：2020/06/15

SERIES OR P/N	CIRCUITS	PACKING METHOD CODE	INNER PACKING NO.	INNER PACKING SIZE (CM)			INNER PACKING Q'TY	INSIDE CARTON NO.			PCS / INSIDE CARTON	CARTON NO.	CARTON SIZE (CM)			PCS / CARTON	G.W REF. (KG)	
				L/D	W	H		L	W	H			L	W	H			
CF504*D0R/G0/1/H-05-NH	04	D	PACK-CRCA119-NH-H	-	1.60	-	3000	PACK-RLCA01-NH-H	-	1.65	-	3000	PACK-CTC034-C/H	35.0	35.0	32.0	33000	
CF505*D0R/G0/1/H-05-NH	05	D	PACK-CRCA242-NH-H	-	1.60	-	3000	PACK-RLCA01-NH-H	-	1.65	-	3000	PACK-CTC034-C/H	35.0	35.0	32.0	33000	
CF506*D0R/G0/1/H-05-NH	06	D	PACK-CRCA118-NH-H	-	1.60	-	3000	PACK-RLCB01-NH-H	-	1.65	-	3000	PACK-CTC034-C/H	35.0	35.0	32.0	33000	
CF508*D0R/G0/1/H-05-NH	08	D	PACK-CRCB508-NH-H	-	2.40	-	3000	PACK-RLCB01-NH-H	-	2.45	-	3000	PACK-CTC034-C/H	35.0	35.0	32.0	27000	
CF509*D0R/G0/1/H-05-NH	09	D	PACK-CRCB673-NH-H	-	2.40	-	3000	PACK-RLCB01-NH-H	-	2.45	-	3000	PACK-CTC034-C/H	35.0	35.0	32.0	27000	
CF5010*D0R/G0/1/H-05-NH	10	D	PACK-CRCB427-NH-H	-	2.40	-	3000	PACK-RLCB01-NH-H	-	2.45	-	3000	PACK-CTC034-C/H	35.0	35.0	32.0	27000	
CF5011*D0R/G0/1/H-05-NH	11	D	PACK-CRCB413-NH-H	-	2.40	-	3000	PACK-RLCB01-NH-H	-	2.45	-	3000	PACK-CTC034-C/H	35.0	35.0	32.0	27000	
CF5012*D0R/G0/1/H-05-NH	12	D	PACK-CRCB429-NH-H	-	2.40	-	3000	PACK-RLCB01-NH-H	-	2.45	-	3000	PACK-CTC034-C/H	35.0	35.0	32.0	27000	
CF5014*D0R/G0/1/H-05-NH	14	D	PACK-CRCB591-NH-H	-	2.40	-	3000	PACK-RLCB01-NH-H	-	2.45	-	3000	PACK-CTC034-C/H	35.0	35.0	32.0	27000	
CF5015*D0R/G0/1/H-05-NH	15	D	PACK-CRCB433-NH-H	-	2.40	-	3000	PACK-RLCB01-NH-H	-	2.45	-	3000	PACK-CTC034-C/H	35.0	35.0	32.0	27000	
CF5016*D0R/G0/1/H-05-NH	16	D	PACK-CRCB428-NH-H	-	2.40	-	3000	PACK-RLCB01-NH-H	-	2.45	-	3000	PACK-CTC034-C/H	35.0	35.0	32.0	27000	
CF5018*D0R/G0/1/H-05-NH	18	D	PACK-CRCB373-NH-H	-	2.40	-	3000	PACK-RLCB01-NH-H	-	2.45	-	3000	PACK-CTC034-C/H	35.0	35.0	32.0	27000	
CF5020*D0R/G0/1/H-05-NH	20	D	PACK-CRCB430-NH-H	-	2.40	-	3000	PACK-RLCB01-NH-H	-	2.45	-	3000	PACK-CTC034-C/H	35.0	35.0	32.0	27000	
CF5024*D0R/G0/1/H-05-NH	24	D	PACK-CRCB583-NH-H	-	2.40	-	3000	PACK-RLCB01-NH-H	-	2.45	-	3000	PACK-CTC034-C/H	35.0	35.0	32.0	27000	
CF5026*D0R/G0/1/H-05-NH	26	D	PACK-CRCC165-NH-H	-	3.20	-	3000	PACK-RLCC01-NH-H	-	3.25	-	3000	PACK-CTC034-C/H	35.0	35.0	32.0	21000	
CF5030*D0R/G0/1/H-05-NH	30	D	PACK-CRCC146-NH-H	-	3.20	-	3000	PACK-RLCC01-NH-H	-	3.25	-	3000	PACK-CTC034-C/H	35.0	35.0	32.0	21000	
CF5036*D0R/G0/1/H-05-NH	36	D	PACK-CRCD136-NH-H	-	4.40	-	3000	PACK-RLCD01-NH-H	-	4.45	-	3000	PACK-CTC034-C/H	35.0	35.0	32.0	15000	
CF5040*D0R/G0/1/H-05-NH	40	D	PACK-CRCD127-NH-H	-	4.40	-	3000	PACK-RLCD01-NH-H	-	4.45	-	3000	PACK-CTC034-C/H	35.0	35.0	32.0	15000	
CF5050*D0R/G0/1/H-05-NH	50	D	PACK-CRCD199-NH-H	-	4.40	-	3000	PACK-RLCD01-NH-H	-	4.45	-	3000	PACK-CTC034-C/H	35.0	35.0	32.0	15000	
CF5054*D0R/G0/1/H-05-NH	54	D	PACK-CRCD229-NH-H	-	4.40	-	3000	PACK-RLCD01-NH-H	-	4.45	-	3000	PACK-CTC034-C/H	35.0	35.0	32.0	15000	
CF5010*D0RK-05-NH	10	D	PACK-CRCB733-NH-H	-	2.40	-	3000	PACK-RLCB01-NH-H	-	2.45	-	3000	PACK-CTC034-C/H	35.0	35.0	32.0	27000	
CF5012*D0RK-05-NH	12	D	PACK-CRCB576-NH-H	-	2.40	-	3000	PACK-RLCB01-NH-H	-	2.45	-	3000	PACK-CTC034-C/H	35.0	35.0	32.0	27000	
CF5020*D0RK-05-NH	20	D	PACK-CRCB577-NH-H	-	2.40	-	3000	PACK-RLCB01-NH-H	-	2.45	-	3000	PACK-CTC034-C/H	35.0	35.0	32.0	27000	
CF5022*D0RK-05-NH	22	D	PACK-CRCB633-NH-H	-	2.40	-	3000	PACK-RLCB01-NH-H	-	2.45	-	3000	PACK-CTC034-C/H	35.0	35.0	32.0	27000	
CF5024*D0RK-05-NH	24	D	PACK-CRCB659-NH-H	-	2.40	-	3000	PACK-RLCB01-NH-H	-	2.45	-	3000	PACK-CTC034-C/H	35.0	35.0	32.0	27000	
CF5026*D0RK-05-NH	26	D	PACK-CRCC179-NH-H	-	3.20	-	3000	PACK-RLCC01-NH-H	-	3.25	-	3000	PACK-CTC034-C/H	35.0	35.0	32.0	21000	
CF5020*D0GT-05-NH	20	D	PACK-CRCC211-NH-H	-	3.20	-	3000	PACK-RLCC01-NH-H	-	3.25	-	3000	PACK-CTC034-C/H	35.0	35.0	32.0	21000	
CF5024*D0GT-05-NH	24	D	PACK-CRCC206-NH-H	-	3.20	-	3000	PACK-RLCC01-NH-H	-	3.25	-	3000	PACK-CTC034-C/H	35.0	35.0	32.0	21000	
CF5008*D0RC-05-NH	08	D	PACK-CRCB532-NH-H	-	2.40	-	3000	PACK-RLCB01-NH-H	-	2.45	-	3000	PACK-CTC034-C/H	35.0	35.0	32.0	27000	

注：紙盤先用塑膠袋（PACK-PBC013-H不穿孔）裝好后再裝入外箱，外箱中有紙板（PACK-STC008-H）兩塊、隔板（PACK-STC001-C/H）三個。

PACKING METHOD (包裝方式) :

1 PE BAG (塑膠袋)
SIZE = L * W

2 TUBE (塑膠管)
SIZE = L * W * H

3 PVC TRAY (塑膠盒)
SIZE = L * W * H

4 REEL (卷盤)
SIZE = D * W

5 BOX (內紙盒)
SIZE = L * W * H

6 INSIDE CARTON (內箱)
SIZE = L * W * H

7 OUTSIDE CARTON (外箱)
SIZE = L * W * H

PACKING METHOD CODE (包裝方式代碼):

- A = 1 → 7
- B = 2 → 7
- C = 3 → 7
- D = (4+1) → 7
- E = 5 → 7
- F = 1 → 6 → 7
- G = 2 → 6 → 7
- H = 3 → 6 → 7

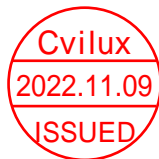

PACKING STANDARD

製訂日期：2020/07/24

SERIES OR P/N	CIRCUITS	PACKING METHOD CODE	INNER PACKING NO.	INNER PACKING SIZE (CM)			INNER PACKING QTY	INSIDE CARTON NO.	INSIDE CARTON SIZE (CM)			PCS / INSIDE CARTON	CARTON NO.	CARTON SIZE (CM)			PCS / CARTON	G.W REF. (KG)
				L	D	W			H	L	W			H	L	W		
CF504*D0R/G0/1-10-NH	04	D	PACK-CRCB405-NH-H	-	2.40	-	3000	PACK-RLCB01-NH-H	-	2.45	-	3000	PACK-CTC034-H	35.0	35.0	32.0	27000	
CF506*D0R/G0/1-10-NH	06	D	PACK-CRCB361-NH-H	-	2.40	-	3000	PACK-RLCB01-NH-H	-	2.45	-	3000	PACK-CTC034-H	35.0	35.0	32.0	27000	
CF508*D0R/G0/1-10-NH	08	D	PACK-CRCB362-NH-H	-	2.40	-	3000	PACK-RLCB01-NH-H	-	2.45	-	3000	PACK-CTC034-H	35.0	35.0	30.0	27000	
CF5090*D0R/G0/1-10-NH	09	D	PACK-CRCB725-NH-H	-	2.40	-	3000	PACK-RLCB01-NH-H	-	2.45	-	3000	PACK-CTC034-H	35.0	35.0	30.0	27000	
CF5010*D0R/G0/1-10-NH	10	D	PACK-CRCB386-NH-H	-	2.40	-	3000	PACK-RLCB01-NH-H	-	2.45	-	3000	PACK-CTC034-H	35.0	35.0	30.0	27000	
CF5012*D0R/G0/1-10-NH	12	D	PACK-CRCC154-NH-H	-	3.20	-	3000	PACK-RLCC01-NH-H	-	3.25	-	3000	PACK-CTC034-H	35.0	35.0	30.0	21000	
CF5018*D0R/G0/1-10-NH	18	D	PACK-CRCD99-NH-H	-	4.50	-	3000	PACK-RLCD01-NH-H	-	4.45	-	3000	PACK-CTC034-H	35.0	35.0	30.0	15000	
CF5024*D0R/G0/1-10-NH	24	D	PACK-CRCD147-NH-H	-	4.50	-	3000	PACK-RLCD01-NH-H	-	4.45	-	3000	PACK-CTC034-H	35.0	35.0	30.0	15000	
CF5026*D0R/G0/1-10-NH	26	D	PACK-CRCD138-NH-H	-	4.50	-	3000	PACK-RLCD01-NH-H	-	4.45	-	3000	PACK-CTC034-H	35.0	35.0	30.0	15000	
CF5030*D0R/G0/1-10-NH	30	D	PACK-CRCE31-NH-H	-	5.60	-	3000	PACK-RLCE01-NH-H	-	5.65	-	3000	PACK-CTC034-H	35.0	35.0	30.0	12000	
CF5006*D0RA/B-10-NH	06	D	PACK-CRCB361-NH-H	-	2.40	-	3000	PACK-RLCB01-NH-H	-	2.45	-	3000	PACK-CTC034-H	35.0	35.0	32.0	27000	
CF5008*D0RA/B-10-NH	08	D	PACK-CRCB362-NH-H	-	2.40	-	3000	PACK-RLCB01-NH-H	-	2.45	-	3000	PACK-CTC034-H	35.0	35.0	32.0	27000	
CF5010*D0RA/B-10-NH	10	D	PACK-CRCB386-NH-H	-	2.40	-	3000	PACK-RLCB01-NH-H	-	2.45	-	3000	PACK-CTC034-H	35.0	35.0	32.0	27000	
CF5010*D0RK-10-NH	10	D	PACK-CRCB578-NH-H	-	2.40	-	3000	PACK-RLCB01-NH-H	-	2.45	-	3000	PACK-CTC034-H	35.0	35.0	32.0	27000	
CF5004*D0R/G4-10-NH	04	D	PACK-CRCA122-NH-H	-	1.60	-	3000	PACK-RLCB01-NH-H	-	1.65	-	3000	PACK-CTC034-H	35.0	35.0	32.0	33000	

注：紙盤先用塑膠袋 (PACK-PBC013-H不打孔) 裝好后再裝入外箱,外箱中有紙板(PACK-STC008-H)兩塊、隔板(PACK-STC001-C/H)三個。

PACKING METHOD (包裝方式):

1 PE BAG (塑膠袋)
SIZE = L * W

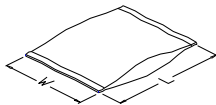

2 TUBE (塑膠管)
SIZE = L * W * H

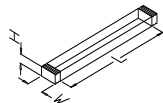

3 PVC TRAY (塑膠盒)
SIZE = L * W * H

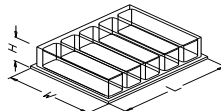

4 REEL (卷盤)
SIZE = D * W

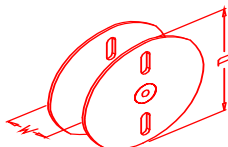

5 BOX (內紙盒)
SIZE = L * W * H

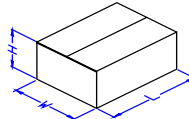

6 INSIDE CARTON (內箱)
SIZE = L * W * H

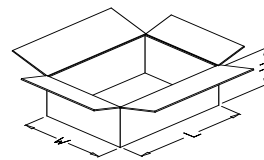

7 OUTSIDE CARTON (外箱)
SIZE = L * W * H

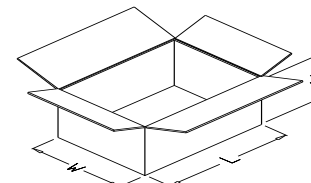

PACKING METHOD CODE (包裝方式代碼):

- A = 1 → 7
- B = 2 → 7
- C = 3 → 7
- D = (4+1) → 7
- E = 5 → 7
- F = 1 → 6 → 7
- G = 2 → 6 → 7
- H = 3 → 6 → 7

文件履歷表

文件編號	CI15F501				
文件名稱	PACKING STANDARD				
內容變更敘述					
版本	新增				發行日期
2	簽呈編號：ISOXR0182007039				2020.08.19
核准	Scott	審核	Angela	製表	劉繼敏
版本	1. 依據 ECRH121070]PACK-CTC034-H 紙箱變更高度尺寸 2. 刪除 CF50*DORD/2/E/F/G/Q/N-**-NH 包規 3. 新增 CF50**DORA/B-10-NH 包規				發行日期
3	簽呈編號：ISOXR0182210029				2022.11.09
核准	Scott	審核	Angela	製表	徐春艷
版本					發行日期
核准		審核		製表	
版本					發行日期
核准		審核		製表	
版本					發行日期
核准		審核		製表	
版本					發行日期
核准		審核		製表	
版本					發行日期
核准		審核		製表	
版本					發行日期
核准		審核		製表	
版本					發行日期
核准		審核		製表	